

FORM B - Building

Massachusetts Historical Commission
Massachusetts Archives Building
220 Morrissey Boulevard
Boston, Massachusetts 02125

Map and Lot # 109-57 USGS Quad Area(s) Form Number 99

Town Groton
Place (neighborhood or village) Groton Center

Photograph

(3"x3" or 3-1/2x5" black and white only) Label photo on back with town and property address. Record film roll and negative numbers here on form. Staple photo to left side of form over this space. Attach additional photos to continuation sheets.

Roll Negative(s)

Sketch Map

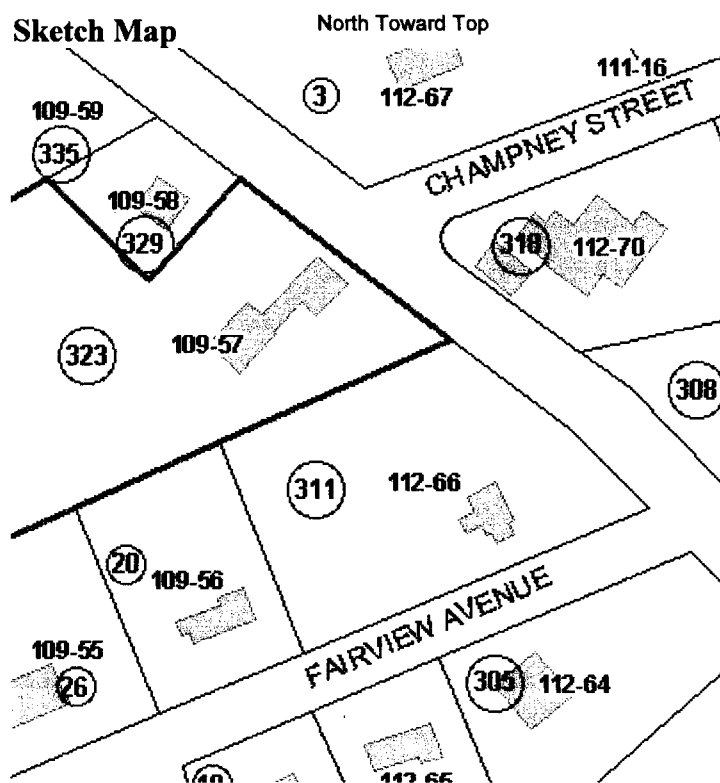

Recorded by Sanford Johnson

Organization Groton Historical Commission

Date (month/year) 12/07

Address 323 Main Street

Historic Name Corey House

Uses: Present Residential

Original Residential

Date of Construction c. 1750

Source Butler's field notes, 1828-1829; Estimate

Style/Form Colonial, Cape Cod form

Architect/Builder

Exterior Material:

Foundation Unknown

Wall/Trim Wood clapboard

Roof Asphalt shingle

Outbuildings/secondary structure

Attached barn

Major Alterations (with dates)

Shed dormer added, c. 1900

Condition Fair

Moved no yes Date 1904

Acreage 4.74

Setting Outside town center

Follow Massachusetts Historical Commission Survey Manual instructions for completing this form.

BUILDING FORM

ARCHITECTURAL DESCRIPTION

see continuation sheet

Describe architectural features. Evaluate the characteristics of this building in terms of other buildings within the community.

- * 323 Main Street is a Colonial style Cape Cod house of 5x2 bays and 1 1/2 stories; the plan is expanded at the east by a 1-story ell attached to gable-roofed barn oriented parallel to the house and ell; The 3/4-width shed dormer has two pairs of 6/6 sash facing south; A second shed dormer occupies the rear slope of the roof and is lit by a single 6/6 window
- * Details include the corner boards, center brick chimney, symmetrical fenestration in the façade and the short corner posts typical of Colonial period construction
- * Windows are 6/6 double-hung sash with a wood frame storm windows; the center entry also has plain trim
- * The ell is accessed by two vehicle doors flanking a 6/6 window;
- * The center brick chimney has a corbelled top
- * The attached bar appears to have been built in the 19th century and is clad in novelty board; a pyramidal ventilator occupies the roof ridge; windows are a combination of 6/6 and fixed 6-pane sash; The entry is not visible from Main Street
- * The house is in fair condition and may be among the older houses in and around Groton Center; An interior examination could reveal more detail about the early construction date

HISTORICAL NARRATIVE

see continuation sheets

Discuss the history of the building. Explain its associations with local (or state) history. Include uses of the building, and the role(s) the owners /occupants played within the community.

According to GHC research, this house was moved from the corner of West and Main Streets in 1904. Butler's 1832 map depicts Abner Mansur at that location. The low corner post height suggests the house has Colonial Period origins. The house was moved to accommodate the Sacred Heart Catholic Church now at 297 Main Street (MHC #196) when it was moved here in 1904. The 1847 and 1856 maps depicts Albert Spalter and then J. H. Spalter as the occupants. Albert Spalter was born in Groton in 1815, married Abby Shattuck in 1838 and had 3 children. He later moved to Rummey, NH. By 1875, it was owned by J. D. Blood. The 1889 county atlas shows E. M. Mason as the owner. By the early 1900s, the owner was one "Cock Eyed" Corey about whom little else is known. Families named Denahy and Durling lived here in the mid 20th century.

BIBLIOGRAPHY and/or REFERENCES

continuation sheet

1856 Walling map of Middlesex County; 1875 Beers atlas; 1889 Walker atlas; 1832 and 1847 Butler maps; Butler's 1829 field notes; Federal census agricultural schedules, 1850-1880; Previous GHC Research; 1896, 1921 Sanborn Fire Insurance map; Resident Directories, 1918, 1929; Butler's town history; Dr. Green, Vol ii, p. 308; 1930 Somes map; Resident directories, 1918, 1929; 1855, 1865 state census;; May, "Houses" p. 35;

**** All properties mentioned in bold type are individually inventoried resources**

- Recommended for listing in the National Register of Historic Places. If checked, you must attach a completed National Register Criteria Statement Form.
-

INVENTORY FORM CONTINUATION SHEET

Town
Groton

Property Address

Massachusetts Historical Commission
220 Morrissey Boulevard
Massachusetts Archives Building
Boston, MA 02125

Area(s)
Form No.



323 Main Street



323 Main Street