

FORM B - Building

**Massachusetts Historical Commission
Massachusetts Archives Building
220 Morrissey Boulevard
Boston, Massachusetts 02125**

Map and Lot # 111-18 USGS Quad Area(s) Form Number 489

Town Groton3
Place (neighborhood or village)

Photograph

(3"x3" or 3-1/2x5" black and white only) Label photo on back with town and property address. Record film roll and negative numbers here on form. Staple photo to left side of form over this space. Attach additional photos to continuation sheets.

Roll Negative(s)

Address 29 Champney Street
Historic Name Monk House
Uses: Present Residential
Original Residential
Date of Construction c. 1880
Source Estimate

Style/Form Victorian Eclectic

Architect/Builder

Exterior Material:

Foundation Brick

Wall/Trim Wood shingle

Roof Asphalt shingle

Outbuildings/secondary structure

Detached garage

Major Alterations (with dates)

Balustrade removed from roof of porch and bay window, 20th c.

Condition Excellent

Moved no yes Date c. 1900

Acres .62

Setting Rural residential street

Sketch Map

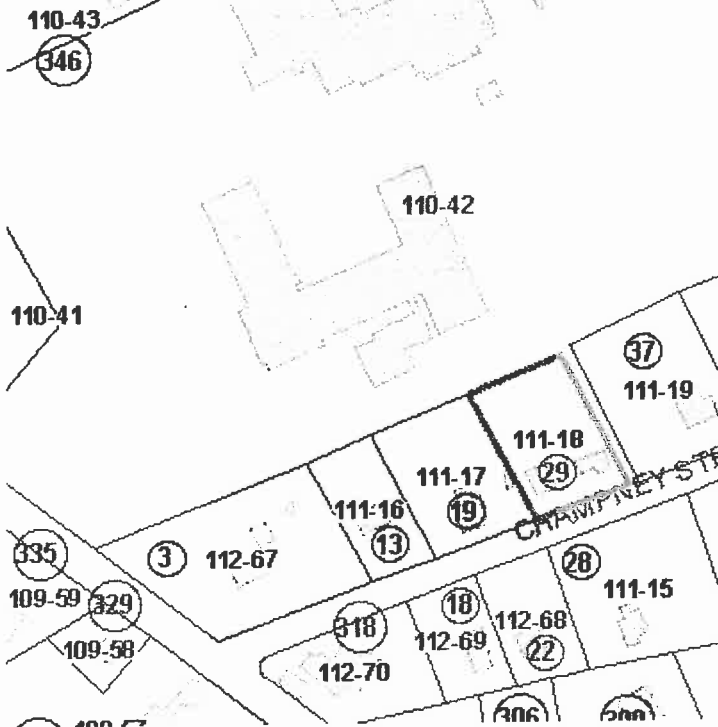

Recorded by Sanford Johnson

Organization Groton Historical Commission

Date (month/year) 12/08

Follow Massachusetts Historical Commission Survey Manual instructions for completing this form.

BUILDING FORM

ARCHITECTURAL DESCRIPTION

see continuation sheet

Describe architectural features. Evaluate the characteristics of this building in terms of other buildings within the community.

- * The house at 29 Champney Street is a 2 1/2-story, cross-gabled, 2x3-bay form with a 1 1/2-story ell at the southwest side and elements of the Victorian Eclectic style; a 2-story bay window projects from the gable front section of the façade; a porch covers the first story at the junction of the main block and the ell
- * Ornament consists of the corner boards, gable returns, molded cornice and jigsawn balusters in the front porch
- * Windows are 1/1 sash in the bay window and double-hung Queen Anne sash elsewhere; slim hoods surmount the otherwise plain trim
- * The side-hall entry and secondary entry under the porch also have plain trim with slim hoods above
- * The house is well-maintained and is of a scale typical for Champney Street
- * The design is remarkably similar to the house at 43 and 47 Champney Street, suggesting they were built by the same builder

HISTORICAL NARRATIVE

see continuation sheets

Discuss the history of the building. Explain its associations with local (or state) history. Include uses of the building, and the role(s) the owners /occupants played within the community.

Champney Street was laid out shortly after publication of the 1889 atlas of Middlesex County. Virginia May's book "Groton Houses" contains a c. 1900 photo of the house and depicts the building as it is today except for the balustrades atop the porch and bay window which no longer exist. The author states the house was moved from a location on Elm Street near Main Street where it served as a shop of unspecified nature. It was owned by the 1930 by Rodney Monk according to the 1930 map of Groton and to Mrs. May.

BIBLIOGRAPHY and/or REFERENCES

continuation sheet

"Groton Houses", pp. 39, 41; Resident directories, 1918, 1929; 1930 Somes map of Groton;

**** All properties mentioned in bold type are individually inventoried resources**

- Recommended for listing in the National Register of Historic Places. If checked, you must attach a completed National Register Criteria Statement Form.
-

INVENTORY FORM CONTINUATION SHEET

Town **Property Address**

Groton

Massachusetts Historical Commission
220 Morrissey Boulevard
Massachusetts Archives Building
Boston, MA 02125

Photos Taken 3-6/08

Area(s)
Form No.



29 Champney St