

FORM B - Building

Massachusetts Historical Commission
Massachusetts Archives Building
220 Morrissey Boulevard
Boston, Massachusetts 02125

Photograph

(3"x3" or 3-1/2x5" black and white only) Label photo on back with town and property address. Record film roll and negative numbers here on form. Staple photo to left side of form over this space. Attach additional photos to continuation sheets.

Roll Negative(s)

Sketch Map

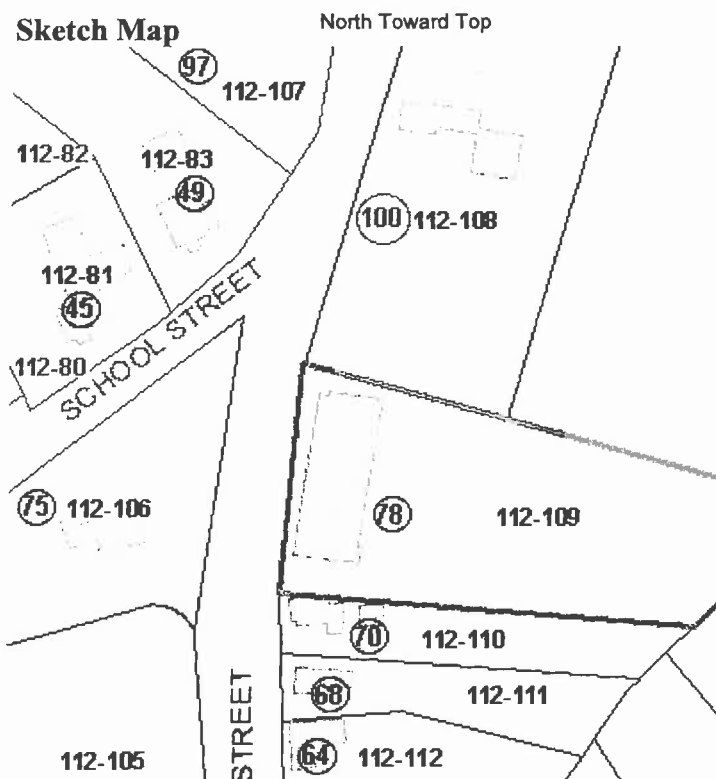

Recorded by Sanford Johnson

Organization Groton Historical Commission

Date (month/year) 12/08

Map and Lot # 112 109 USGS Quad Area(s) Y Form Number 341

Town Groton3

Place (neighborhood or village)

Groton Center

Address 78 Hollis Street

Historic Name Boutwell School

Uses: Present School

Original School

Date of Construction 1914

Source Town report

Style/Form Spanish Revival; Panel Brick

Architect/Builder W. H. & Henry McLean, architects

Exterior Material:

Foundation Granite

Wall/Trim Brick

Roof Metal

Outbuildings/secondary structure

Major Alterations (with dates)

Rehabilitated, c. 1990

Condition Excellent

Moved no yes Date

Acreage 1.8

Setting Town Center

Follow Massachusetts Historical Commission Survey Manual instructions for completing this form.

BUILDING FORM

ARCHITECTURAL DESCRIPTION

see continuation sheet

Describe architectural features. Evaluate the characteristics of this building in terms of other buildings within the community.

* Boutwell School is a Spanish Revival style design of one story and seven bays of 3 windows each; the long gabled roof runs parallel to Hollis Street and is marked at both ends by gabled pavilions trimmed with semi circular crests featuring ornamental book motifs in cast stone; deep eaves with exposed rafter ends cover the façade

* The recessed central entrance is trimmed with Renaissance ornament including brick pilasters laid in herringbone pattern, entablature and circular crest rising above the eave line; a single lamp in cast stone surmounts the south side of the entry surround, the other likely having been lost

* Windows, which are mainly 6/6 double-hung sash with plain trim, flank secondary entrances at two locations in the façade; other sash are tripled to maintain symmetry

* Additional decorative features include the octagonal ventilators along the roof ridge, corner quoins at the edges of the pavilions and Panel Brick style wall field trim

HISTORICAL NARRATIVE

see continuation sheets

Discuss the history of the building. Explain its associations with local (or state) history. Include uses of the building, and the role(s) the owners /occupants played within the community.

Construction of the Boutwell School began in November, 1914 and opened for classes in the fall of 1915 according to the town report from that year. This was just one year after construction was completed on the Tarbell School, Boutwell's West Groton counterpart. Architects for the Boutwell School were W. H. and Henry McLean according to the Massachusetts Archives Fire Safety Plan file. Land for the school was bought from Abel Lawrence and the final cost of the project was approximately \$23,000. A cottage and barn were removed from the parcel and relocated prior to construction. The decision to name the building for ex-governor George S. Boutwell was decided unanimously at the 1915 town meeting. Governor Boutwell (1818-1905) served as a state representative from 1842-1850, governor from 1851-1853, U.S. representative from 1863-1869, U.S. Secretary of the Treasury from 1869-1873 under President Grant, and U.S. senator from 1873-1877. He resided at 172 Main Street in the house that now contains the collection of the Groton Historical Society (MHC #4). Consolidation of the town's 14 district schools began at the start of the 20th century and was nearly completed with construction of the Boutwell School. Two district schools remained after 1916. Boutwell remained in use as a school until further consolidation in 1951. It was sold in 1953 to a private owner for use as professional offices. The office use lasted until the 1990s when the school was returned to use as a pre-school, a purpose it continues to serve.

BIBLIOGRAPHY and/or REFERENCES

continuation sheet

1915 Town Report; Political Graveyard.com; Groton at 350, pp. 85, 86, 90, 216; Groton Landmark, August 1, 1914, November 11, 1914;

**** All properties mentioned in bold type are individually inventoried resources**

Recommended for listing in the National Register of Historic Places. If checked, you must attach a completed National Register Criteria Statement Form.

INVENTORY FORM CONTINUATION SHEET

Town **Property Address**
Groton

Massachusetts Historical Commission
220 Morrissey Boulevard
Massachusetts Archives Building
Boston, MA 02125

Photos Taken 3-6/08

Area(s)
Form No.



78 Hollis St, Boutwell School