

FORM B - Building

Massachusetts Historical Commission
 Massachusetts Archives Building
 220 Morrissey Boulevard
 Boston, Massachusetts 02125

Map and Lot # 113 14 USGS Quad Y Area(s) Form Number 145

Town Groton3
 Place (neighborhood or village) Lawrence Academy, Groton Center

Photograph

Address 77 Main Street
 Historic Name Loomis House
 Uses: Present Dormitory
 Original Residence
 Date of Construction c. 1905

(3"x3" or 3-1/2x5" black and white only) Label photo on back with town and property address. Record film roll and negative numbers here on form. Staple photo to left side of form over this space. Attach additional photos to continuation sheets.

Roll Negative(s)

Source Previous Research
 Style/Form Queen Anne

Architect/Builder

Exterior Material:

Foundation Brick

Wall/Trim Wood clapboard

Roof Slate shingle

Outbuildings/secondary structure

Detached Carriage Shed

Major Alterations (with dates)

Condition Excellent

Moved no yes Date

Acreage .6

Setting Town Center

Sketch Map

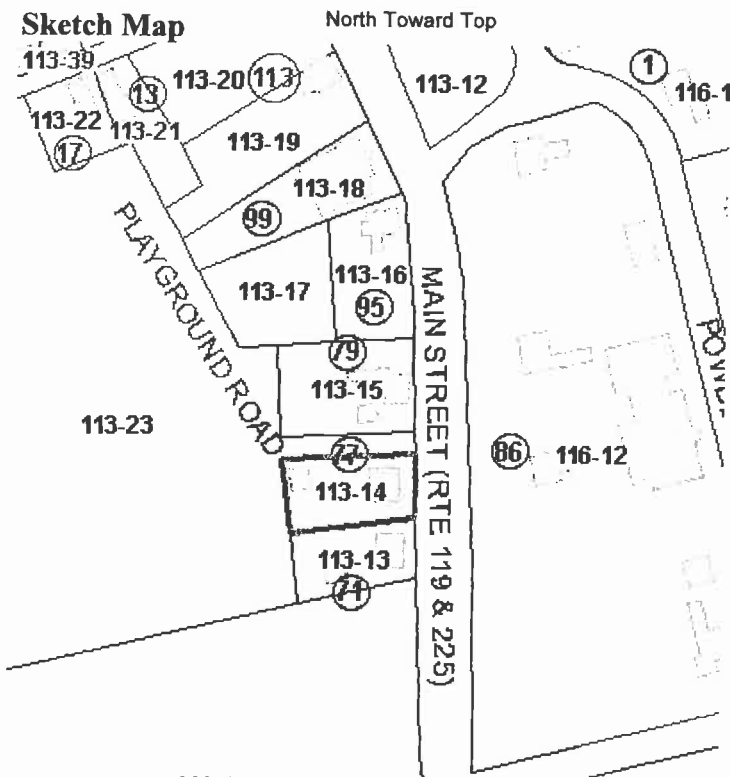

Recorded by Sanford Johnson

Organization Groton Historical Commission

Date (month/year) 12/08

Follow Massachusetts Historical Commission Survey Manual instructions for completing this form.

BUILDING FORM

ARCHITECTURAL DESCRIPTION

see continuation sheet

Describe architectural features. Evaluate the characteristics of this building in terms of other buildings within the community.

* The Queen Anne style design is 3x3 bays and two and one half stories tall with a ridge-hipped roof and a nearly square plan; Secondary masses include the gabled dormers on the front and sides as well as an octagonal tower at the northeast corner; canted corners articulate the edges of the façade

* Windows are mainly 1/1 double hung sash with a Queen Anne sash in the third story of the tower and a tripartite sash in the front dormer

* The main entry in the façade is covered by an open gable roofed porch supported by paired square columns on plinth blocks; a hipped porch supported by square columns on plinth blocks covers most of the south elevation and the secondary entry

* Details include the scroll cut ornament under the canted soffits at the corners of the façade, deep eaves, molded cornice and the locally unusual tower with octahedral roof clad in slate, also locally rare

* The detached carriage barn, now in use as a garage, is a side-gabled, wood clapboard form of two stories with flared shingles in the gable ends, a gabled dormer in the center of the east slope and a pyramidal ventilator with square base in the center of the roof ridge; Like the house, the barn roof is clad in slate shingles; The barn is more ornate than most others in Groton center although is relatively small

HISTORICAL NARRATIVE

see continuation sheets

Discuss the history of the building. Explain its associations with local (or state) history. Include uses of the building, and the role(s) the owners /occupants played within the community.

The house at 77 Main Street, named Loomis house by the current owner, Lawrence Academy, may have been built c. 1905 by the carpenter Henry Morton Adams who lived here with his wife Alice and son Lester from at least 1918 (according to the resident directory from that year) until Henry's death in 1938 (aged 84) and Alice's in 1940 (aged 80). The Adams' name is associated with the house on the 1930 Somes map of Groton and the 1942 map in Douglas Frank's school history. Lester worked for his father from at least 1918-1929 and died in 1931 at the age of 50. Tax valuations from 1923 indicate Henry owned a house, garage, barn and shop on 1/4 acre, all worth \$4,700, far more than average for Groton. The number of outbuildings suggests he ran his business on the premises. In the early 1900s, Henry was active in town as the manager of the Groton Ideal Orchestra which specialized in dance music. He played the violin, mandolin and the bells in addition to performing in plays, recitals and readings at the Grange Hall, Town Hall and Squannacook Hall as well as the Grange Hall in Littleton where he performed his composition "The Pansy March" at a wedding in 1911. Mr. Adams' work included construction of a barn on Jenkins Road in 1909, repairs to Dana House (MHC #23) at Lawrence Academy in 1912 and renovations at the Groton Grange (MHC #198). He may have been responsible for construction on Adams Avenue (possibly named for him) off Pleasant Street in Groton Center. According to the 1930 map of Groton, he owned houses at 64 and 68 West Main Street in West Groton and may have built them himself after a fire destroyed his rental cottage in 1909. The house at 77 Main Street now serves as a dormitory for students at Lawrence Academy. The LA Trustees voted on June 7, 1947 to purchase the house from Winthrop L. Sheedy for \$12,000. It was renamed Loomis House on June 5, 1948 (for Elihu G. Loomis, Class of 1870, trustee, 1900-1930 and opened to house 14 boys in 1948). It was a dorm run by LA teacher Frank Head until 1963 when it became a faculty residence for two families. In 1966 it was reconverted to a dorm and has been such until the present day.

BIBLIOGRAPHY and/or REFERENCES

continuation sheet

Doug Frank, p. 298; Groton Birth Marriage and Death Records; Groton Tax Valuations, 1923; Groton Landmark, various dates; 1930 Somes Map of Groton; Resident Directories, 1918, 1929; 1942 Stanley Scott Map of Groton Center; Virginia May, Groton Houses; Department of Public Safety Fire Safety Records; Files of Lawrence Academy Archivist Richard Jeffers and interview, 3/7/08/; Frank, p. 304;

** *All properties mentioned in bold type are individually inventoried resources*

Recommended for listing in the National Register of Historic Places. If checked, you must attach a completed National Register Criteria Statement Form.

INVENTORY FORM CONTINUATION SHEET

Town

Property Address

Groton

Massachusetts Historical Commission
220 Morrissey Boulevard
Massachusetts Archives Building
Boston, MA 02125

Photos Taken 3-6/08

Area(s)

Form No.



77 Main Street, Loomis House, Lawrence Academy



77 Main Street, Loomis House, Lawrence Academy