

FORM B - Building

Massachusetts Historical Commission
Massachusetts Archives Building
220 Morrissey Boulevard
Boston, Massachusetts 02125

Map and Lot # 102 22 USGS Quad W Area(s) Form Number 233

Town Groton3
Place (neighborhood or village) West Groton

Photograph

(3"x3" or 3-1/2x5" black and white only) Label photo on back with town and property address. Record film roll and negative numbers here on form. Staple photo to left side of form over this space. Attach additional photos to continuation sheets.

Roll Negative(s)

Address 17 Pepperell Road

Historic Name

Uses: Present Residential

Original Residential

Date of Construction c. 1890

Source Estimate

Style/Form Victorian Eclectic

Architect/Builder

Exterior Material:

Foundation Undetermined

Wall/Trim Wood clapboards, wood shingles

Roof Asphalt shingles

Outbuildings/secondary structure

Attached barn, c. 1890

Major Alterations (with dates)

Windows appear to be modern replacements

Condition Good

Moved no yes Date

Acreage .33

Setting Rural, edge of West Groton village

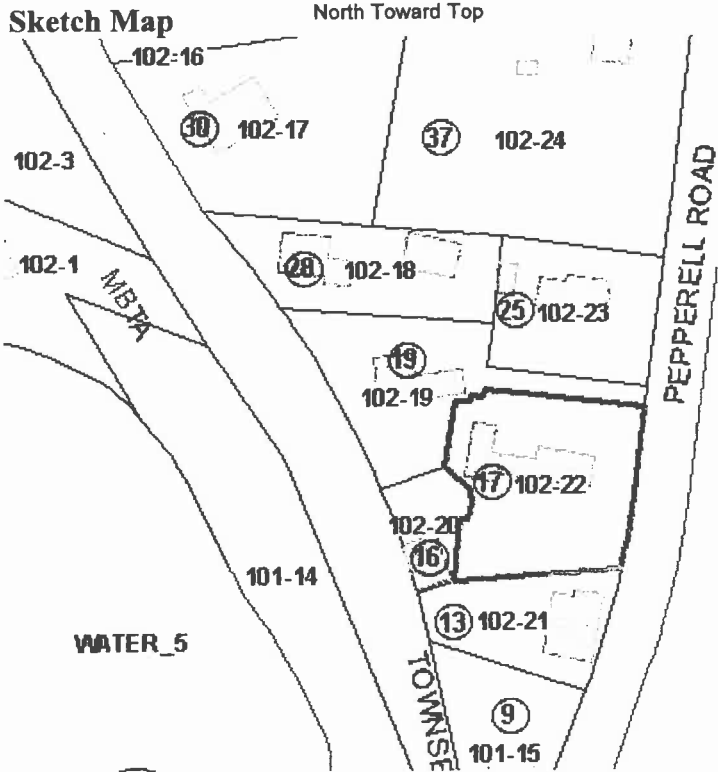

Recorded by Sanford Johnson

Organization Groton Historical Commission

Date (month/year) 12/08

Follow Massachusetts Historical Commission Survey Manual instructions for completing this form.

BUILDING FORM

ARCHITECTURAL DESCRIPTION

see continuation sheet

Describe architectural features. Evaluate the characteristics of this building in terms of other buildings within the community.

- * The house at 17 Pepperell Road is a Victorian Eclectic style, front gabled design of 2 1/2 stories and 3x3 bays; a 1-story rear ell attaches the house to the barn; the first story of the façade is covered by a full width porch with a shed roof; a shed roofed open porch expands the plan at the south side elevation
- * Decorative features include the patterned wood shingles in the façade gable peak, corner boards with brackets at the eaves and molded cornice; similar brackets mark the eaves of the front porch
- * Windows are modern double-hung sash with hoods and plain trim; windows in the gable peak and under the front porch are paired
- * The house is well-maintained and resembles other Victorian examples in the neighborhood in terms of scale, design quality and materials; it is particularly similar to the house and barn at 39 Pepperell Road

HISTORICAL NARRATIVE

see continuation sheets

Discuss the history of the building. Explain its associations with local (or state) history. Include uses of the building, and the role(s) the owners /occupants played within the community.

The house at 17 Pepperell Road appears to have been built after publication of the 1889 Middlesex County atlas but appears on the 1930 map as the property of James J. Moran, a laborer living with his wife Mary.

BIBLIOGRAPHY and/or REFERENCES

continuation sheet

1930 map of Groton; 1929 Resident Directory

**** All properties mentioned in bold type are individually inventoried resources**

Recommended for listing in the National Register of Historic Places. If checked, you must attach a completed National Register Criteria Statement Form.

INVENTORY FORM CONTINUATION SHEET

Town
Groton

Property Address

Massachusetts Historical Commission
220 Morrissey Boulevard
Massachusetts Archives Building
Boston, MA 02125

Photos Taken 3-6/08

Area(s)
Form No.



17 Pepperell Road