

FORM B - Building

Massachusetts Historical Commission
Massachusetts Archives Building
220 Morrissey Boulevard
Boston, Massachusetts 02125

Photograph

(3"x3" or 3-1/2x5" black and white only) Label photo on back with town and property address. Record film roll and negative numbers here on form. Staple photo to left side of form over this space. Attach additional photos to continuation sheets.

Roll Negative(s)

Sketch Map

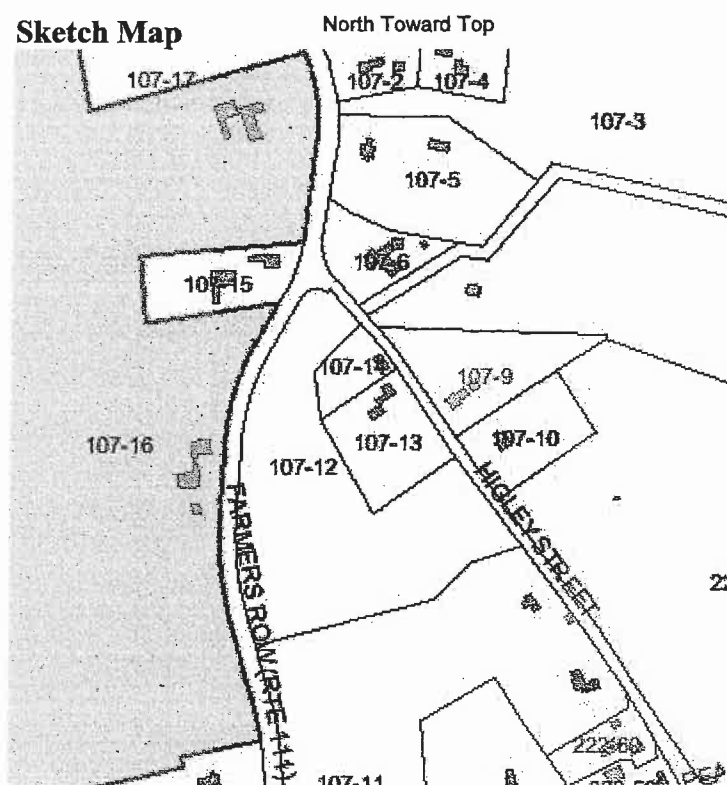

Recorded by Sanford Johnson

Organization Groton Historical Commission

Date (month/year) 6/06

Map and Lot # 107 16 USGS Quad Area(s) X Form Number 86

Town Groton

Place (neighborhood or village)

Farmers Row

Address 182 Farmers Row

Historic Name Eaton, Joshua House

Uses: Present Residential

Original Residential-agricultural

Date of Construction c. 1790

Source Previous GHS research

Style/Form Federal

Architect/Builder

Exterior Material:

Foundation Granite

Wall/Trim Wood clapboard

Roof Asphalt shingle

Outbuildings/secondary structure

Attached 19th c. barn, detached modern garage

Major Alterations (with dates)

Detached barns north of house demolished, 2005

Condition Excellent

Moved no yes Date

Acreage 119

Setting Rural

Follow Massachusetts Historical Commission Survey Manual instructions for completing this form.

BUILDING FORM

ARCHITECTURAL DESCRIPTION

see continuation sheet

Describe architectural features. Evaluate the characteristics of this building in terms of other buildings within the community.

- * The Federal style Joshua Eaton House is a 5x2-bay, 2 1/2-story, side-gabled form with a 2-story rear ell and 1-story addition at the south side that connects the barn; a gable-roofed entry porch covers the center entry; a three-sided bay window expands the plan of the main block at the south side
- * Decorative features include the entry porch with classical details including Doric columns, entablature, dentils and modillions, molded cornice with modillions, gable returns, corner pilasters with molded bases and capitals, plain entry surround with sidelights and flanking pilasters and the symmetrical fenestration in the main block; two brick chimneys rise from the rear slope of the roof
- * Windows are 6/6 double-hung sash with beaded trim and hoods on the first story
- * The attached barn is approximately 30'x40', is clad in wood clapboards, has a rolling vehicle door with transom facing east toward the road in the gable end; paired fixed 12-pane sash light the door; a 4/8 double hung unit is in the gable peak; a weathervane occupies the roof peak; a second vehicle door gives access to the ell connecting the house and barn
- * The house is well-maintained and is typical of the high style estate-scale properties common on Farmers Row; the large open parcel with expansive views to the west, the denticulated cornice and porch provide the house with a high level of architectural significance

HISTORICAL NARRATIVE

see continuation sheets

Discuss the history of the building. Explain its associations with local (or state) history. Include uses of the building, and the role(s) the owners /occupants played within the community.

The earliest known owner of 182 Farmers Row is Joshua Eaton whose occupancy is depicted on the 1832 Butler map. Caleb Butler describes the house in its current form in his 1828-29 field notes and notes that it was painted yellow. Mr. Eaton may also have owned the house at 227 Boston Road (MHC #64) by 1847. Mr. Eaton's son Joshua Eaton Jr. is depicted at this location on Butler's map from 1847. By 1856, the owner was J. Pollard who is listed in census records as a yeoman, 65 years of age, married to Betsy and living with his son Alfred, also a yeoman. From c. 1865-c. 1875, the owner was Osgood Putnam who is listed in 1855 census schedules as a 53 year-old farmer with his wife named Rhoda and 10 children. By the time of the 1880 Non-population Census Schedules, Rhoda is listed as the farm owner, suggesting Osgood had died by that time, although agricultural production continued on 80 acres with 13 milk cows and an acre of orchard. The 1889 Walker atlas depicts the property as the estate of Osgood Putnam which by then appears from the 1888 resident directory to have been occupied by his daughters Mattie and Laura. By 1939, the land was used for pasture and growing hay.

BIBLIOGRAPHY and/or REFERENCES

continuation sheet

1832 and 1847 Butler maps and field notes; 1875 Beers atlas; 1889 Walker atlas; 1856 Walling map; 1939 WPA map; Tax records, 1830-1889; 1888 resident directory; 1855, 1865 state census; Non-population Census Schedules;

**** All properties mentioned in bold type are individually inventoried resources**

- Recommended for listing in the National Register of Historic Places. If checked, you must attach a completed National Register Criteria Statement Form.
-

INVENTORY FORM CONTINUATION SHEET

Town
Groton

Property Address

Massachusetts Historical Commission
220 Morrissey Boulevard
Massachusetts Archives Building
Boston, Massachusetts 02125

Area(s)

Form No.

182 Farmers Row



Massachusetts Historical Commission

Community Groton

Property Address

182 Farmers Row

Massachusetts Archives Building

220 Morrissey Boulevard

Boston, Massachusetts 02125

Area(s)

Form No.

X

National Register of Historic Places Criteria Statement Form

Check all that apply:

Individually eligible X

Eligible only in a historic district

Contributing to a potential historic district X

Potential historic district

Criteria: A B C D

Criteria considerations: A B C D E F G

Statement of significance by: Sanford Johnson

The criteria that are checked in the above sections must be justified here.

The Federal Style Eaton House at 182 Farmers Row is potentially eligible for the National Register of Historic Places as an individual resource at the local level. The earliest known owner of 182 Farmers Row is Joshua Eaton whose occupancy is depicted on the 1832 Butler map. Caleb Butler refers to the house in his 1828-29 field notes for his maps and notes that it was painted yellow. He may also have owned the house at 227 Boston Road (MHC #64) by 1847. Mr. Eaton's son Joshua Eaton Jr. is depicted by Butler on his map from 1847. Butler refers to Farmers Row in his 1847 town history, indicating the name had been applied by that time. By 1856, the owner was J. Pollard who is listed in census records as a yeoman, 65 years of age, married to Betsy and living with his son Alfred, also a yeoman. The building's associations with historic agricultural activity in Groton establish its significance under Criterion A. The design of the large, well-maintained house's symmetrical façade, well maintained barn and its setting with views across historic agricultural fields to Mount Wachusett make the property eligible under Criterion C. The house retains integrity of design, materials, setting and workmanship.