

# FORM B - Building

Massachusetts Historical Commission  
Massachusetts Archives Building  
220 Morrissey Boulevard  
Boston, Massachusetts 02125

Map and Lot # 220 28 USGS Quad Area(s) Form Number 44, 210

Town Groton  
Place (neighborhood or village)

## Photograph

(3"x3" or 3-1/2x5" black and white only) Label photo on back with town and property address. Record film roll and negative numbers here on form. Staple photo to left side of form over this space. Attach additional photos to continuation sheets.

Roll Negative(s)

Address 518 Farmers Row  
Historic Name Moors, Benjamin House  
Uses: Present Residential  
Original Residential-agricultural  
Date of Construction c. 1825

Source Butler's field notes, 1828-29

Style/Form Federal

Architect/Builder

Exterior Material:

Foundation Field stone

Wall/Trim Wood clapboard

Roof Asphalt shingle

Outbuildings/secondary structure

Detached barn

Major Alterations (with dates)

Garage added, mid 20th c.

Condition Excellent

Moved no  yes  Date

Acreage 3.52

Setting Rural

## Sketch Map

North Toward Top

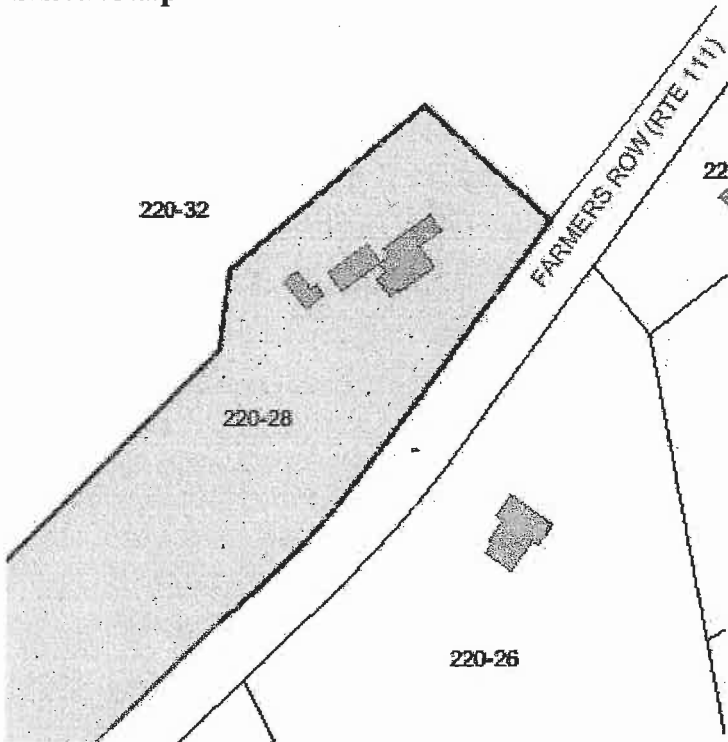

Recorded by Sanford Johnson

Organization Groton Historical Commission

Date (month/year) 6/06

Follow Massachusetts Historical Commission Survey Manual instructions for completing this form.

## BUILDING FORM

### ARCHITECTURAL DESCRIPTION

see continuation sheet

*Describe architectural features. Evaluate the characteristics of this building in terms of other buildings within the community.*

- \* The Benjamin Moors House is a 5x2-bay, pyramidal-hipped, 2-story form with a 2-story ell on the north side, a 1-story shed on the southwest corner and an enclosed shed porch attached to the south elevation; a stout brick chimney rises from the peak of the pyramidal roof
- \* Federal style details include the slim corner boards, molded cornice with dentils, symmetrical fenestration in the façade and the classical surround at the center entry that consists of a pediment with molded, denticulated cornice supported by pilasters flanking the door
- \* The shed at the southwest corner contains three garage bays accessed by segmental arched doorways; the north ell has a shed dormer occupying half the length of the roof and a modern garage door with transom in the northern end
- \* Windows are 12/12 double-hung sash with beaded trim on the second story and 6/6 with hoods on the first
- \* The detached barn in the southwest of the yard is a front gambrel form of 1 1/2 stories; siding is vertical flushboard
- \* The house is well-maintained and is typical of the high style estate-scale properties common on Farmers Row; the large open parcel with expansive views to the west, the denticulated cornice and entry surround provide the house with a high level of architectural significance

### HISTORICAL NARRATIVE

see continuation sheets

*Discuss the history of the building. Explain its associations with local (or state) history. Include uses of the building, and the role(s) the owners /occupants played within the community.*

John Farnsworth occupied a previous house on this site in the 18th century and sold the property to the weaver Abraham Moors, a native of England, in 1716/17. Abraham's son Joseph also lived here and was a veteran of the French and Indian War battle at Louisbourg, Cape Breton in 1758 and later in the Battle of Bunker Hill and in New York during the Revolution. Joseph served the town in the Massachusetts General Court for 9 years in the early 1800s. Part of the older house may comprise part of the current construction according to previous GHS research. The farm was the site in the 18th century of a sawmill that had been removed by 1848 according to Butler. Benjamin Moors is depicted as the owner of 518 Farmers Row on Butler's maps from 1832 and 1847. Mr. Moors served as selectman in 1832, master of the Groton Masons' Lodge and grew and processed hops on the property based on recollections of a hop barn and hop field on the property in the mid 19th century. Mr. Moors is listed in tax records in 1830 and 1847 as the owner of real property valued at \$5,700-\$6,500 which is above the average for Groton and commensurate with the scale of the house. Butler's field notes from 1828-29 describe the house in its current form with five windows across the two-story façade and a single chimney. From c. 1850-1855, this was the home of the farmer and wheelwright Aaron Mason, a temperant Millerite who moved here from Groton center and, according to Richardson, removed the hop barn and crop. Non-population Census Schedules from 1850 show he had 127 acres and still produced \$1,200 in hops, although he produced no hops by 1860. Subsequent owners were Elisha Gould Culver from 1855-c. 1857, Mr. Harriman from c. 1857-1859, William Chase from 1859-1867. Nathan F. Culver lived here from 1867-1883 according to Richardson, had a relatively large herd of 14 cows and butchered \$500 worth of animals according to the 1870 Non-population Census Schedules. Elisha G. Culver and Nathan F. Culver are listed in state census records as farmers. Nathan Culver is listed in tax record from 1875 as the owner of 3 horses, 20 cows and a bull on 84 acres as well as a building referred to as the Community House,

### BIBLIOGRAPHY and/or REFERENCES

continuation sheet

Butler, 247, 213, 244, 252, 279; Edward A. Richardson, "The Community", pp. 6, 12, 18; Resident Directories, 1918, 1929; Tax records, 1830-1889; 1888 resident directory; 1855, 1865 state census; 1832, 1847 Butler maps; 1856 Walling map; 1875 Beers atlas; 1889 Walker atlas; Non-population Census Schedules;

\*\* All properties mentioned in bold type are individually inventoried resources

- Recommended for listing in the National Register of Historic Places. If checked, you must attach a completed National Register Criteria Statement Form.

**INVENTORY FORM CONTINUATION SHEET**

Massachusetts Historical Commission  
220 Morrissey Boulevard  
Massachusetts Archives Building  
Boston, Massachusetts 02125

**Town**                      **Property Address**

Groton

**Area(s)**                      **Form No.**

**518 Farmers Row                      Historical Narrative**

probably the former workshop used by Millerite residents of the neighborhood in the 1840s. Followers of William Miller believed his predictions of the end of the world in 1847 and gathered in the neighborhood to await the Ascension while working at woodworking and farming. From c. 1918-1930, the occupant was a farmer named John Storer.

**INVENTORY FORM CONTINUATION SHEET**

**Town**  
Groton

**Property Address**

Massachusetts Historical Commission  
220 Morrissey Boulevard  
Massachusetts Archives Building  
Boston, Massachusetts 02125

**Area(s)**

**Form No.**

518 Farmers Row



**INVENTORY FORM CONTINUATION SHEET**

Massachusetts Historical Commission  
220 Morrissey Boulevard  
Massachusetts Archives Building  
Boston, Massachusetts 02125

**Town**  
Groton

**Property Address**

**Area(s)**

**Form No.**

518 Farmers Row



Massachusetts Historical Commission

Massachusetts Archives Building  
220 Morrissey Boulevard  
Boston, Massachusetts 02125

Community Groton  
Property Address  
518 Farmers Row

Area(s)

Form No.

### National Register of Historic Places Criteria Statement Form

Check all that apply:

Individually eligible  X

Eligible only in a historic district

Contributing to a potential historic district

Potential historic district

Criteria:  A  B  C  D

Criteria considerations:  A  B  C  D  E  F  G

Statement of significance by: Sanford Johnson

*The criteria that are checked in the above sections must be justified here.*

The Federal Style Moors House at 518 Farmers Row is potentially eligible for the National Register of Historic Places as an individual resource at the local level. John Farnsworth occupied a previous house on this site in the 18th century and sold the property to the weaver Abraham Moors, a native of England, in 1716/17. Abraham's son Joseph also lived here and was a veteran of the French and Indian War battle at Louisbourg, Cape Breton in 1758 and later in the Battle of Bunker Hill and in New York during the Revolution. Joseph served the town in the Massachusetts General Court for 9 years in the early 1800s. Part of the older house may comprise part of the current construction according to previous GHC research. The farm was the site in the 18th century of a sawmill that had been removed by 1848 according to Butler. Benjamin Moors is depicted as the owner of 518 Farmers Row on Butler's maps from 1832 and 1847. Mr. Moors served as selectman in 1832, master of the Groton Masons' Lodge and grew and processed hops on the property based on recollections of a hop barn and hop field on the property in the mid 19th century. The building's associations with historic agricultural and commercial activity in Groton establish its significance under Criterion A. The design of the well-maintained house's symmetrical façade, hipped roof and its setting with views toward Mount Wachusett make the property eligible under Criterion C. The house retains integrity of design, materials, setting and workmanship.