

FORM B - Building

Massachusetts Historical Commission
Massachusetts Archives Building
220 Morrissey Boulevard
Boston, Massachusetts 02125

Map and Lot # 221 67 USGS Quad Area(s) Form Number 49, 221

Town Groton
Place (neighborhood or village)

Photograph

(3"x3" or 3-1/2x5" black and white only) Label photo on back with town and property address. Record film roll and negative numbers here on form. Staple photo to left side of form over this space. Attach additional photos to continuation sheets.

Roll Negative(s)

Address 310 Old Ayer Road
Historic Name Stone, James House
Uses: Present Residential - Agricultural
Original Residential - Agricultural
Date of Construction c. 1840
Source Butler's 1828-29 field notes

Style/Form Federal

Architect/Builder

Exterior Material:

Foundation Granite

Wall/Trim Wood clapboards

Roof Asphalt shingle

Outbuildings/secondary structure

Detached 19th century barn

Major Alterations (with dates)

Main block added, c. 1840; original windows replaced w/ 2/2 sash

Condition Good

Moved no yes Date

Acreage 4.44

Setting Rural

Sketch Map

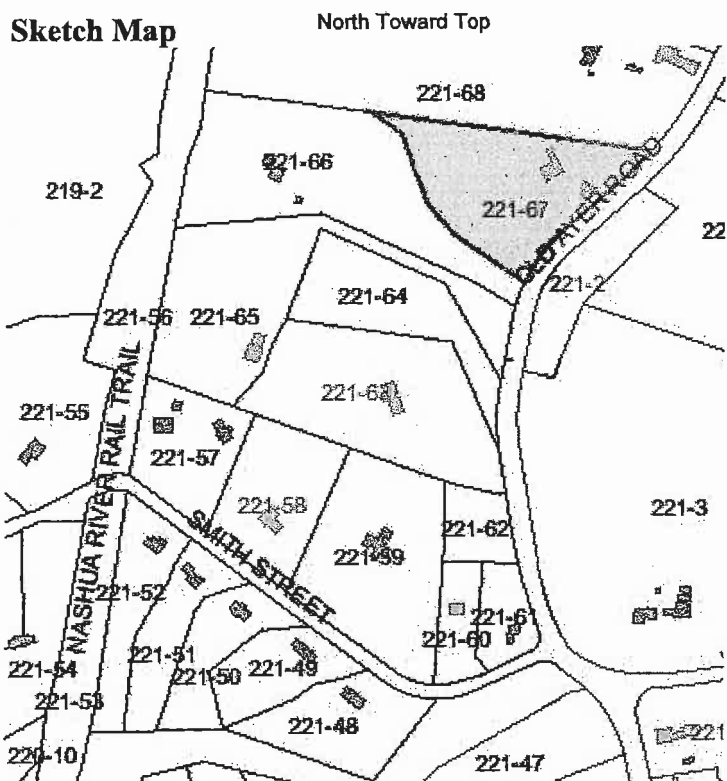

Recorded by Sanford Johnson

Organization Groton Historical Commission

Date (month/year) 6/06

Follow Massachusetts Historical Commission Survey Manual instructions for completing this form.

BUILDING FORM

ARCHITECTURAL DESCRIPTION

see continuation sheet

Describe architectural features. Evaluate the characteristics of this building in terms of other buildings within the community.

- * 310 Old Ayer Road is a side-gabled, 2 1/2-story, 5x1-bay form with elements of the Federal style; two perpendicular rear additions of successively lower ridge height have been made to the main block; a garage of 1 1/2 stories connects to the second addition
- * Decorative features include the symmetrical fenestration in the façade, corner boards, closed gable and molded cornice
- * The center entry has a classical surround composed of a slim hood in the place of the cornice over the frieze and architrave; sidelights and pilasters flank the door; a secondary entry with plain trim exists in the south side of the second addition
- * Windows in the main block are 2/2 double-hung sash; those in the rear additions are 6/6 double-hung sash
- * The detached barn measures approximately 30'x60'; the gable end with the principal entry faces northeast toward the house; access here is via a large vehicle opening filled by a rolling door with a transom above; other openings are the pedestrian door in the southeast elevation; this side is also lit by four barn sash, or, fixed 6-pane sash
- * Horse paddocks exist in the south side yard, indicating the ongoing agricultural use of the property
- * The house was the subject of a rehabilitation project in the early 2000s and is in excellent condition

HISTORICAL NARRATIVE

see continuation sheets

Discuss the history of the building. Explain its associations with local (or state) history. Include uses of the building, and the role(s) the owners /occupants played within the community.

The core of the house at 310 Old Ayer Road may have been built as early as 1780 and appears on Butler's map published in 1832. The occupant, James Stone, was also depicted as the owner on maps from 1847 and 1856. Mr. Stone's real property in 1830 consisted of the land, a house and barn which were valued at \$1,800. Butler's field notes from 1828-29 indicate the house was an old one-story form with a "bevel roof", suggesting a construction date for the house shortly after 1830. By 1847, the valuation was \$3,000, and by 1850, \$4,000, suggesting the farm was substantially improved between those years. While the increased value may have come from added acreage, architectural details such as the high corner posts, closed gable and sidelights at the entry suggest the possibility that the main block is a late Federal style design and was added between 1832 and 1847. The census of 1855 indicates James Stone was born c. 1788 and had 5 children. By 1865, Mr. Stone's son Henry was the head of the household and lived here with his three sisters, Anne, Martha and Harriet. The 1875 atlas indicates Henry remained until at least that time. A subsequent owner was Alonzo E. Tainter, a farmer according to the 1888 resident directory. Tax records show he had 2 horses, 6 cows and a carriage which were typical for a farmer in Groton. People named Bowles and Harrison Hatch, who was listed as a farmer at this location in the 1918 resident directory, were later owners. The 1929 directory indicates Mr. Hatch's wife Catherine also was in residence.

BIBLIOGRAPHY and/or REFERENCES

continuation sheet

Butler Maps of 1832, 1847 and field notes; Walling map of 1856; Beers Atlas of 1875; Walker atlas of 1889; Resident Directories, 1888, 1918, 1929; Tax records from 1830-1889; State census, 1855, 1865; 1930 Groton map; Non-population Census Schedules;

**** All properties mentioned in bold type are individually inventoried resources**

- Recommended for listing in the National Register of Historic Places. If checked, you must attach a completed National Register Criteria Statement Form.
-

INVENTORY FORM CONTINUATION SHEET

Town
Groton

Property Address

Massachusetts Historical Commission
220 Morrissey Boulevard
Massachusetts Archives Building
Boston, Massachusetts 02125

Area(s)

Form No.

310 Old Ayer Road



INVENTORY FORM CONTINUATION SHEET

Town
Groton

Property Address

Massachusetts Historical Commission
220 Morrissey Boulevard
Massachusetts Archives Building
Boston, Massachusetts 02125

Area(s)

Form No.

310 Old Ayer Road



Massachusetts Historical Commission

Massachusetts Archives Building
220 Morrissey Boulevard
Boston, Massachusetts 02125

Community Groton
Property Address
310 Old Ayer Road

Area(s)

Form No.

National Register of Historic Places Criteria Statement Form

Check all that apply:

Individually eligible X

Eligible only in a historic district

Contributing to a potential historic district

Potential historic district

Criteria: A B C D

Criteria considerations: A B C D E F G

The Federal Style house at 310 Old Ayer Road is potentially eligible for the National Register of Historic Places as an individual resource at the local level. The core of the house at 310 Old Ayer Road may have been built as early as 1780 and appears on Butler's map published in 1832. The occupant, James Stone, was also depicted as the owner on maps from 1847 and 1856. Mr. Stone's real property in 1830 consisted of the land, a house and barn which were valued at \$1,800, an average amount for Groton. Butler's field notes from 1828-29 indicate the house was an old one-story form with a "bevel roof", suggesting a construction date for the house shortly after 1830. By 1847, the valuation was \$3,000, suggesting the farm was substantially improved between those years. While the increased value may have come from added acreage, architectural details such as the high corner posts, closed gable and sidelights at the entry suggest the possibility that the main block is a late Federal style design and was added between 1832 and 1847. The building's associations with agricultural activities establish its significance under Criterion A. The design of the symmetrical façade, the surviving exterior materials and the 19th century barn make the property eligible under Criterion C. The house retains integrity of design, materials, setting and workmanship.